



GRUNDFOS UPMXXL PHEX PUMP KIT



Low energy
consumption



Compact size



Low flow
noise



High
efficiency



Cascade
compatible

For Evomax 2 Cascades installed with
Ideal Commercial Plate Heat Exchanger

DIMENSIONS & CLEARANCES

ALL DIMENSIONS IN MM

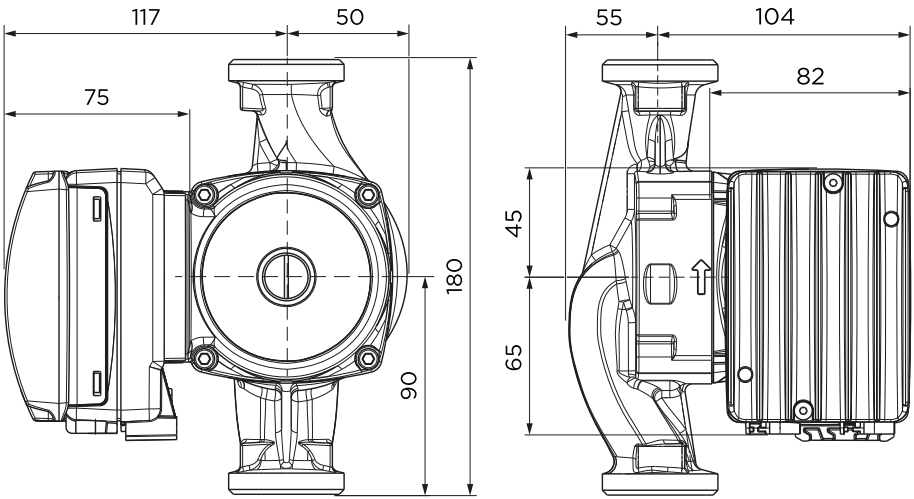

CONTROL BOX POSITIONS



TECHNICAL SPECIFICATION

UIN	222660	NET WEIGHT	3.2kg
CONNECTIONS	G 1 ½	ENCLOSURE CLASS	IPX2D
SYSTEM PRESSURE	Max. 1.0 MPa (10 bar)	INSULATION CLASS	H
MAXIMUM INLET PRESSURE	0.01 MPa (0.10 bar) at 95°C liquid temperature	EQUIPMENT CLASS	I
LIQUID PRESSURE	-10°C to +95°C (TF 95)	APPROVAL AND MARKING	VDE, CE
MOTOR PROTECTION	Overload protection	QUANTITY NEEDED	1 per boiler on Cascade

PERFORMANCE OVERVIEW

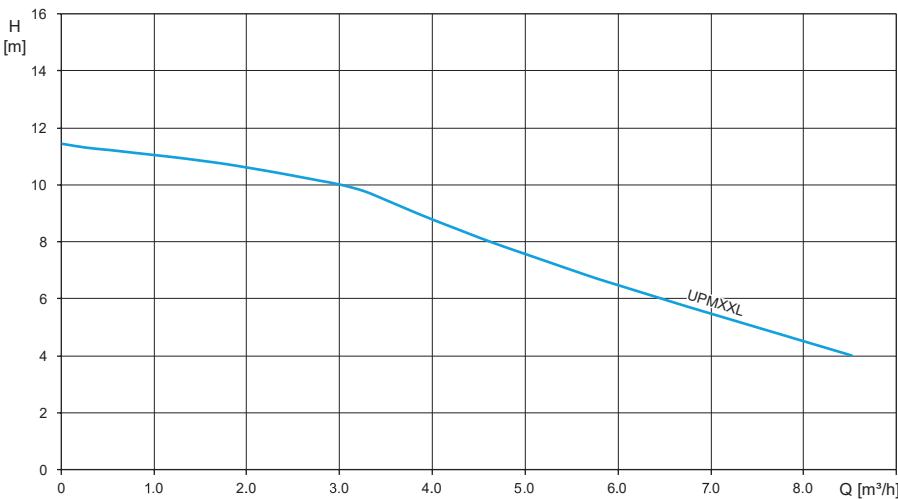

Compatible with PWM speed control for use with Evomax 2 boilers.

Supplied with:

- 0-10V/PWM wiring harness
- 2 x washers